

Request details    Options    Review    Publish

**Priority request**  
 Mark this request as priority to receive faster responses from suppliers

~~Sealed bidding~~  
 ~~Hide competing offers. Suppliers cannot see other bids until the request is closed~~

**Private request**  
 Visible only to registered suppliers and not indexed by search engines

**Notify relevant suppliers**  
 Suppliers subscribed to the manufacture or category will be notified

[Go Back](#)    [Continue](#)

You can review and edit everything before publishing

Please completely remove the “Sealed bidding” option (checkbox + all related text).

**Caterpillar**    [Priority](#)    [Send quote](#)

**108420-16**    [View details →](#)

+ 1 more part    Please only “Priority”, without request.

10 Jan 2026 Germany    Active ★ IMB265

Update remaining texts as follows:

Priority request

Mark this request as priority to indicate time-critical demand

Selective visibility

Visible only to logged-in, verified users — not indexed by search engines

Notify relevant suppliers

Suppliers subscribed to this category or manufacturer will be notified

Priority request

Mark this request as ASAP to indicate time-critical demand

Selective visibility

Visible only to logged-in, verified users — not indexed by search engines

Notify relevant suppliers

Suppliers subscribed to this category or manufacturer will be notified

[Submit](#)

## Messages

### Technical requirements — Messaging (Chat)

#### 1. RFQ reference in chat

Each chat must be linked to a specific RFQ.

At the top of the conversation display the RFQ reference (ID + Machine name):

Example:

RFQ MB265 – Caterpillar 8X3748

This ensures both buyer and supplier clearly understand which RFQ the conversation refers to.

#### 2. Message button behavior

When the user clicks Message in a quote or RFQ view: the system must open the chat with that specific supplier the chat must automatically be linked to the corresponding RFQ

This ensures the conversation is always tied to the correct RFQ.

#### 3. File attachments in chat

The chat must allow users to attach files.

Supported actions:

Attach file

send PDF or image files

This allows suppliers and buyers to exchange:

catalogs

technical specifications

product photos

documents

#### 4. Chat behavior after RFQ closure

When an RFQ is closed, the related chat should become read-only.

Users can still view the conversation history, but cannot send new messages.

## Messages adjustment, 02.04

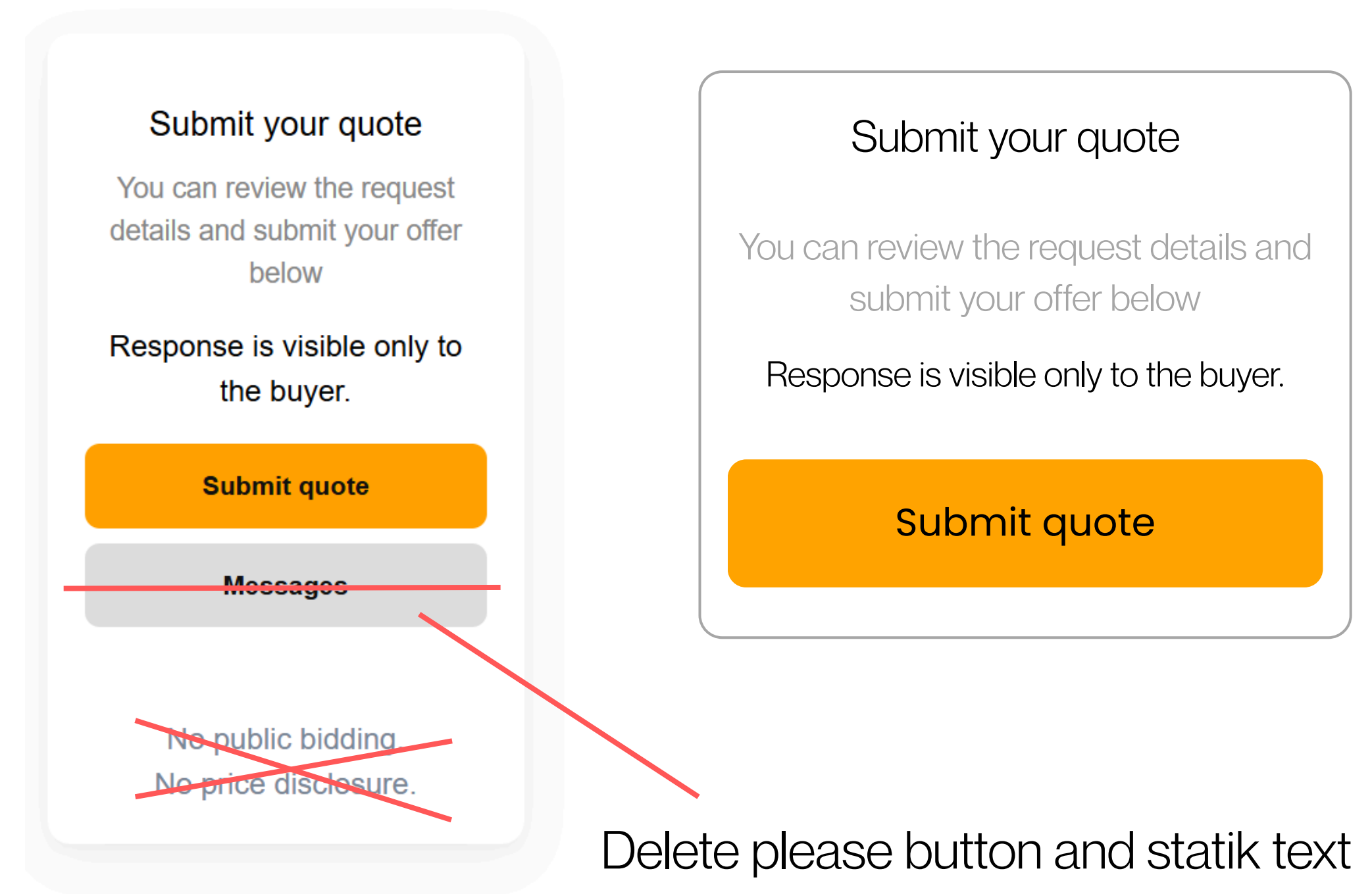

ID	RFQ Title	My Quote (USD)	
MB265	<b>Caterpillar</b> 8X3748 <b>108420-16</b> + 1 more part	800	Not selected View RFQ
MB295	<b>Kubota</b> GF-15 <b>DF214</b>	1800	Open View RFQ
MB285	<b>Caterpillar</b> 8X3748 <b>108420-16</b> + 25 more part	11540	Won View RFQ
15.03.2026	14 Days	\$5900	<del>Message</del> Edit Bid Withdraw
Quote details / notes			[Collapse]

Delete please button message from "My Quote"

Please remove the "Message" button from the following sections:

My Quotes

Request overview (RFQ list)

**The messaging function should be available only within "My Requests", where the buyer manages incoming quotes.**

### My Request

ID	RFQ Title	Budget, USD	
MB4691	<b>Belaz</b> kji87 tr54124	Not specified	0 quotes View Quotes
MB3630	<b>Cummins</b> NOR-12FG FG-123 + 2 more part	Not specified	1 quotes View Quotes
	45 Days	No Files \$4681	Message Email Choose winner
			Close RFQ (no winner) Collapse

Please rename statuses as follows and remove additional text

New  
Closed  
Active

New (no quotes)  
 Closed requests are hidden by default  
 Active (has quotes)

**Submit your quote**

You can review the request details and submit your offer below

Response is visible only to the buyer.

Submit quote

Wear part

**Caterpillar** Priority Send quote

**108420-16** View details →

+ 1 more part

10 Jan 2026 Germany Active ★ IMB265

**Caterpillar** Send quote

**108420-16** View details →

+ 1 more part

10 Jan 2026 Germany New ★ IMB265

ID	RFQ Title		Status	Action
MB265	<b>Caterpillar</b>	8X3748 <b>108420-16</b> + 1 more part	New	View details → ★
MB295	<b>Kubota</b>	GF-15 <b>DF214</b>	Active	View details → ★
MB285	<b>Caterpillar</b>	8X3748 <b>108420-16</b> + 25 more part	Closed	View details →

Filter Options

Request ID

Manufacturer  
Select manufacturer

Category / Type  
Select one or more

Assembly     Spare part  
 Repair     Wear parts

Location  
Select country

Status

New (no quotes)  
 Active (has quotes)

Closed requests are hidden by default

Published

Last 7 days  
 Last 14 days  
 Last 30 days

Apply filters

Reset filters →